

HYDROWEB

Raccordi Maschi
Males
Aussengewindenippel

MGN

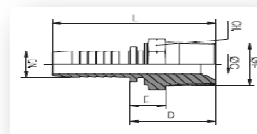

NPTF		DN	TUBO	CH	FILETTO F	L	C	D	E
AGN 1/8" 05	MGN0302	3/16"	05	12	1/8" NPTF	44	3	22	12
AGN 1/8" 06	MGN0402	1/4"	06	12	1/8" NPTF	50	4	22	12
AGN 1/4" 06	MGN0404	1/4"	06	14	1/4" NPTF	53,5	4	25,5	12
AGN 1/4" 10	MGN0604	3/8"	10	16	1/4" NPTF	55	7	25,5	12
AGN 3/8" 06	MGN0406	1/4"	06	19	3/8" NPTF	54	4	26	12
AGN 3/8" 08	MGN0506	5/16"	08	19	3/8" NPTF	54	5,5	26	12
AGN 3/8" 10	MGN0606	3/8"	10	19	3/8" NPTF	56,5	7	27	13
AGN 3/8" 13	MGN0806	1/2"	13	19	3/8" NPTF	57,5	9,5	28	14
AGN 1/2" 10	MGN0608	3/8"	10	22	1/2" NPTF	61	7	31,5	13
AGN 1/2" 13	MGN0808	1/2"	13	22	1/2" NPTF	62	9,5	32,5	13,5
AGN 1/2" 16	MGN1008	5/8"	16	24	1/2" NPTF	68	12,5	34	15
AGN 3/4" 13	MGN0812	1/2"	13	27	3/4" NPTF	64,5	9,5	35	16
AGN 3/4" 19	MGN1212	3/4"	19	27	3/4" NPTF	76,5	15	37,5	17,5
AGN 1" 19	MGN1216	3/4"	19	36	1" NPTF	80,5	15	41,5	17,5
AGN 1" 25	MGN1616	1"	25	36	1" NPTF	88,5	19,5	41,5	17,5
AGN 1"1/4 25	MGN1620	1"	25	46	1"1/4 NPTF	91,5	19,5	44,5	18,5
AGN 1"1/4 32	MGN2020	1"1/4	32	46	1"1/4 NPTF	101	26	46,5	20,5
AGN 1"1/2 38	MGN2424	1"1/2	38	50	1"1/2 NPTF	105,5	32	47,5	20,5
AGN 2" 50	MGN3232	2"	50	65	2" NPTF	127,5	42	55	24

Raccordi maschi filetto metrico sede 24° ISO 12151-2 (ISO 8434-1)

Males 24° metric thread ISO 12151-2 (ISO 8434-1)

Aussengewindenippel 24° metrisch Gewind ISO 12151-2 (ISO 8434-1)

MDL

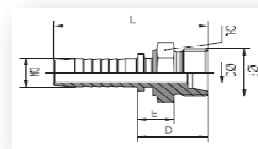

DESCRIZIONE	CODICE	DN	TUBO	CH	FILETTO F	L	C	D	E
CEL 06L 05	MDL0312	3/16"	05	14	M 12x1,5	43	3	21	11
CEL 06L 06	MDL0412	1/4"	06	14	M 12x1,5	49	4	21	11
CEL 08L 06	MDL0414	1/4"	06	17	M 14x1,5	49	4	21	11
CEL 10L 06	MDL0416	1/4"	06	17	M 16x1,5	50	4	22	11
CEL 10L 08	MDL0516	5/16"	08	17	M 16x1,5	50	5,5	22	11
CEL 10L 10	MDL0616	3/8"	10	17	M 16x1,5	52,5	7	23	12
CEL 12L 06	MDL0418	1/4"	06	19	M 18x1,5	51	4	23	12
CEL 12L 08	MDL0518	5/16"	08	19	M 18x1,5	51	5,5	23	12
CEL 12L 10	MDL0618	3/8"	10	19	M 18x1,5	52,5	7	23	12
CEL 15L 10	MDL0622	3/8"	10	24	M 22x1,5	53,5	7	24	12
CEL 15L 13	MDL0822	1/2"	13	24	M 22x1,5	54,5	9,5	25	13
CEL 18L 13	MDL0826	1/2"	13	27	M 26x1,5	55,5	9,5	26	14
CEL 18L 16	MDL1026	5/8"	16	27	M 26x1,5	60	12,5	26	14
CEL 22L 19	MDL1230	3/4"	19	32	M 30x2	68,5	15	29,5	15,5
CEL 28L 25	MDL1636	1"	25	41	M 36x2	77,5	19,5	30,5	16,5
CEL 35L 32	MDL2045	1"1/4	32	46	M 45x2	91	26	36,5	20,5
CEL 42L 38	MDL2452	1"1/2	38	55	M 52x2	95,5	32	37,5	21,5