

# HYDROWEB

Codoli metrici per Raccordi ISO 8434-1 Serie leggera  
Standpipes for ISO 8434-1 Fittings Light  
Rohrstutzen für ISO 8434-1 Verschraubungen Leicht

## PLD

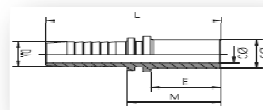

DESCRIZIONE	CODICE	DN	TUBO		D	L	C	M	E
BEL 06L 05	PLD0306	3/16"	05		06L	50,5	3	28,5	23
BEL 06L 06	PLD0406	1/4"	06		06L	57,5	4	29,5	23
L/S 08L 06	PLD0408	1/4"	06		08L	58,5	4	30,5	24
BEL 10L 08	PLD0510	5/16"	08		10L	59,5	5,5	31,5	25
BEL 10L 10	PLD0610	3/8"	10		10L	62	7	32,5	25
BEL 12L 10	PLD0612	3/8"	10		12L	62,5	7	33	25
BEL 15L 10	PLD0615	3/8"	10		15L	61	7	31,5	25
BEL 15L 13	PLD0815	1/2"	13		15L	63	9,5	33,5	25
BEL 18L 13	PLD0818	1/2"	13		18L	65	9,5	35,5	27
BEL 18L 16	PLD1018	5/8"	16		18L	69,5	12,5	33,5	27
BEL 22L 16	PLD1022	5/8"	16		22L	71,5	12,5	37,5	29
BEL 22L 19	PLD1222	3/4"	19		22L	79	15	40	29
BEL 28L 25	PLD1628	1"	25		28L	87	19,5	40	30
BEL 35L 32	PLD2035	1 1/4"	32		35L	103	26	48,5	36
BEL 42L 38	PLD2442	1 1/2"	38		42L	110,5	32	52,5	40

Codoli metrici per Raccordi ISO 8434-1 Serie leggera  
Standpipes for ISO 8434-1 Fittings Light  
Rohrstutzen für ISO 8434-1 Verschraubungen Leicht

## PL9

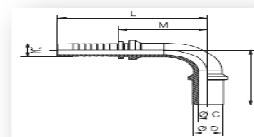

DESCRIZIONE	CODICE	DN	TUBO		D	L	C	M	E
BEL 90 06L05	PL90306	3/16"	05		06L	47,5	3	25,5	41,5
BEL 90 06L06	PL90406	1/4"	06		06L	57	4	29	41,5
L/S 90 08L 06	PL90408	1/4"	06		08L	57	4	29	42,5
BEL 90 10L 08	PL90510	5/16"	08		10L	57,5	5,5	29,5	46
BEL 90 10L 10	PL90610	3/8"	10		10L	63	7	33,5	51
BEL 90 12L 10	PL90612	3/8"	10		12L	63	7	33,5	51
BEL 90 15L 13	PL90815	1/2"	13		15L	71,5	9,5	42	56
BEL 90 18L 13	PL90818	1/2"	13		18L	71,5	9,5	42	59,5
BEL 90 18L 16	PL91018	5/8"	16		18L	87	12,5	53	68
BEL 90 22L16	PL91022	5/8"	16		22L	87	12,5	53	72
BEL 90 22L19	PL91222	3/4"	19		22L	99	15	60	72,5
BEL 90 28L25	PL91628	1"	25		28L	126	19,5	79	86
BEL 90 35L32	PL92035	1 1/4"	32		35L	150,5	26	96	106

Codoli metrici per Raccordi ISO 8434-1 Serie pesante  
Standpipes for ISO 8434-1 Fittings Heavy  
Rohrstutzen für ISO 8434-1 Verschraubungen Schwer

## PLD

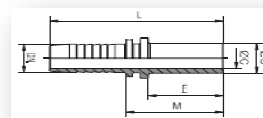

DESCRIZIONE	CODICE	DN	TUBO		D	L	C	M	E
BES 08S 05	PLD0308	3/16"	05		08S	51,5	3	29,5	24
BES 10S 06	PLD0410	1/4"	06		10S	60,5	4	32,5	25
BES 12S 06	PLD0412	1/4"	06		12S	59,5	4	31,5	25
BES 12S 08	PLD0512	5/16"	08		12S	60	5,5	32	25
BES 14S 10	PLD0614	3/8"	10		14S	66	7	36,5	29
BES 14S 13	PLD0814	1/2"	13		14S	67	9,5	37,5	29
BES 16S 13	PLD0816	1/2"	13		16S	70	9,5	40,5	32
BES 20S 16	PLD1020	5/8"	16		20S	78,5	12,5	44,5	36
BES 20S 19	PLD1220	3/4"	19		20S	86	15	47	36
BES 25S 19	PLD1225	3/4"	19		25S	90	15	51	40
BES 25S 25	PLD1625	1"	25		25S	97	19,5	50	40
BES 30S 25	PLD1630	1"	25		30S	102	19,5	55	45
BES 38S 32	PLD2038	1 1/4"	32		38S	117	26	62,5	50

# HYDROWEB

Codoli metrici per Raccordi ISO 8434-1 Serie pesante  
Standpipes for ISO 8434-1 Fittings Heavy  
Rohrstutzen für ISO 8434-1 Verschraubungen Schwer

## PL9

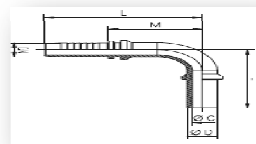

DESCRIZIONE CODICE	DN TUBO		D	L	C	M	E
BES 90 10S 06 PL90410	1/4" 06		10S	57	4	29	43,5
BES 90 12S 06 PL90412	1/4" 06		12S	57	4	29	43,5
BES 90 12S 08 PL90512	5/16" 08		12S	57,5	5,5	29,5	46
BES 90 14S 10 PL90614	3/8" 10		14S	63	7	33,5	55
BES 90 14S 13 PL90814	1/2" 13		14S	71,5	9,5	42	60
BES 90 16S 13 PL90816	1/2" 13		16S	71,5	9,5	42	63
BES 90 20S 16 PL91020	5/8" 16		20S	87	12,5	53	78
BES 90 20S 19 PL91220	3/4" 19		20S	99	15	60	80,5
BES 90 25S 19 PL91225	3/4" 19		25S	99	15	60	84,5
BES 90 25S 25 PL91625	1" 25		25S	126	19,5	79	96
BES 90 30S 25 PL91630	1" 25		30S	126	19,5	79	101

Raccordi orientabili a Occhio  
Banjos  
Ringstutzen

## 015

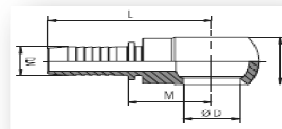

DESCRIZION	CODICE	DN TUBO		D	L	M	E
RNR 1/4" 06	0150404	1/4" 06		G 1/4"	49,5	21,5	14
RNR 3/8" 08	0150506	5/16" 08		G 3/8"	52,5	24,5	18
RNR 3/8" 10	0150606	3/8" 10		G 3/8"	54	24,5	18
RNR 1/2" 10	0150608	3/8" 10		G 1/2"	59,5	30	22
RNR 1/2" 13	0150808	1/2" 13		G 1/2"	60,5	31	22
RNR 5/8" 13	0150810	1/2" 13		G 5/8"	63	33,5	23,5
RNR 5/8" 16	0151010	5/8" 16		G 5/8"	67,5	33,5	23,5
RNR 3/4" 16	0151012	5/8" 16		G 3/4"	72	38	29
RNR 3/4" 19	0151212	3/4" 19		G 3/4"	78,5	39,5	29
RNR 1" 19	0151216	3/4" 19		G 1"	87	48	38
RNR 1" 25	0151616	1" 25		G 1"	95	48	38

Raccordi orientabili a Occhio  
Banjos  
Ringstutzen

## 028

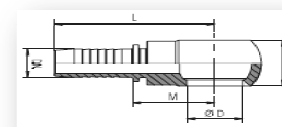

DESCRIZION	CODICE	DN TUBO		D	L	M	E
RNM 12 06	0280412	1/4" 06		M 12	46,5	18,5	12,5
RNM 14 06	0280414	1/4" 06		M 14	49,5	21,5	14
RNM 14 08	0280514	5/16" 08		M 14	54,5	26,5	14
RNM 14 10	0280614	3/8" 10		M 14	56	26,5	14
RNM 16 08	0280516	5/16" 08		M 16	52,5	24,5	18
RNM 16 10	0280616	3/8" 10		M 16	54	24,5	18
RNM 18 10	0280618	3/8" 10		M 18	57	27,5	20
RNM 18 13	0280818	1/2" 13		M 18	58	28,5	20
RNM 22 13	0280822	1/2" 13		M 22	60,5	31	22
RNM 22 16	0281022	5/8" 16		M 22	69,5	35,5	22
RNM 26 16	0281026	5/8" 16		M 26	72	38	29
RNM 26 19	0281226	3/4" 19		M 26	78,5	39,5	29
RNM 30 19	0281230	3/4" 19		M 30	82	43	30