

HYDROWEB

Raccordi Femmina BSP Sede 80° con O-Ring
 BSP Females 80° Cone with O-Ring
 BSP 80° Dichtkegel mit O-Ring

F4G

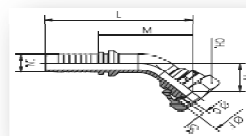

LEGENDA
a PRESSATO
b LIBERO

DESCRIZIONE	CODICE	DN	TUBO	CH	FILETTO F	L	C	H	M	
OR 45 1"1/4 25	F4G1620	1"	25	50	G1"1/4	134,5	19,5	32	87,5	b
OR 45 1"1/4 32	F4G2020	1"1/4	32	50	G1"1/4	165	26	45,5	110,5	a
OR 45 1"1/2 32	F4G2024	1"1/4	32	55	G 1"1/2	165	26	45	110,5	a
OR 45 1"1/2 38	F4G2424	1"1/2	38	55	G 1"1/2	187,5	32	49,5	129,5	a
OR 45 2" 38	F4G2432	1"1/2	38	70	G 2"	189,5	32	51,5	131,5	a
OR 45 2" 50	F4G3232	2"	50	70	G 2"	231,5	42	67	159	a

Raccordi Femmina Filetto metrico Sede 24° ISO 12151-2 (ISO 8434-1) Serie leggera con O-Ring
 Metric Females 24° Cone ISO 12151-2 (ISO 8434-1) Light with O-Ring
 Metrisch 24° Dichtkegel ISO 12151-2 (ISO 8434-1) Leicht mit O-Ring

FDL

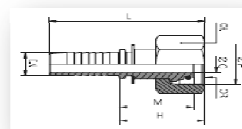

DESCRIZIONE	CODICE	DN	TUBO	CH	FILETTO F	L	C	H	M
DKOL 06L 05	FDL0312	3/16"	05	14	M 12x1,5	47,5	3	25,5	23,5
DKOL 06L 06	FDL0412	1/4"	06	14	M 12x1,5	49,5	3	21,5	18,5
DKOL 08L 06	FDL0414	1/4"	06	17	M 14x1,5	55	4	27	24
DKOL 10L 06	FDL0416	1/4"	06	19	M 16x1,5	54	4	26	24
DKOL 10L 08	FDL0516	5/16"	08	19	M 16x1,5	54,5	5,5	26,5	24
DKOL 10L 10	FDL0616	3/8"	10	19	M 16x1,5	54	6,5	24,5	22
DKOL 12L 06	FDL0418	1/4"	06	22	M 18x1,5	55,5	4	27,5	25
DKOL 12L 08	FDL0518	5/16"	08	22	M 18x1,5	55,5	5,5	27,5	25
DKOL 12L 10	FDL0618	3/8"	10	22	M 18x1,5	56,5	7	27	25
DKOL 15L 10	FDL0622	3/8"	10	27	M 22x1,5	59,5	7	30	27
DKOL 15L 13	FDL0822	1/2"	13	27	M 22x1,5	60,5	9,5	31	28
DKOL 18L 13	FDL0826	1/2"	13	32	M 26x1,5	62,5	9,5	33	29,5
DKOL 18L 16	FDL1026	5/8"	16	32	M 26x1,5	67	12,5	33	30
DKOL 22L 19	FDL1230	3/4"	19	36	M 30x2	75,5	15	36,5	32
DKOL 28L 25	FDL1636	1"	25	41	M 36x2	85	19,5	38	34
DKOL 35L 32	FDL2045	1"1/4	32	50	M 45x2	99	26	44,5	40
DKOL 42L 38	FDL2452	1"1/2	38	60	M 52x2	102	32	44	40

Raccordi Femmina Filetto metrico Sede 24° ISO 12151-2 (ISO 8434-1) Serie leggera con O-Ring
 Metric Females 24° Cone ISO 12151-2 (ISO 8434-1) Light with O-Ring
 Metrisch 24° Dichtkegel ISO 12151-2 (ISO 8434-1) Leicht mit O-Ring

F9L

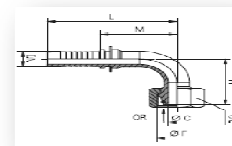

DESCRIZIONE	CODICE	DN	TUBO	CH	FILETTO F	L	C	H	M	
DKOL 90 06L 05	F9L0312	3/16"	05	14	M 12x1,5	48,5	3	29	26,5	b
DKOL 90 06L 06	F9L0412	1/4"	06	14	M 12x1,5	57	3	30,5	29	a
DKOL 90 08L 06	F9L0414	1/4"	06	17	M 14x1,5	55	4	30,5	27	b
DKOL 90 10L 06	F9L0416	1/4"	06	19	M 16x1,5	55	4	33	27	b
DKOL 90 10L 08	F9L0516	5/16"	08	19	M 16x1,5	58	5,5	31,5	30	b
DKOL 90 10L 10	F9L0616	3/8"	10	19	M 16x1,5	63	6,5	40,5	33,5	a
DKOL 90 12L 08	F9L0518	5/16"	08	22	M 18x1,5	58	5,5	32,5	30	b
DKOL 90 12L 10	F9L0618	3/8"	10	22	M 18x1,5	64	7	37	34,5	b
DKOL 90 15L 13	F9L0822	1/2"	13	27	M 22x1,5	72,5	9,5	41,5	43	b
DKOL 90 18L 16	F9L1026	5/8"	16	32	M 26x1,5	88	12,5	50,5	54	b
DKOL 90 22L 19	F9L1230	3/4"	19	36	M 30x2	99,5	15	54,5	60,5	b
DKOL 90 28L 25	F9L1636	1"	25	41	M 36x2	127	19,5	66	80	b
DKOL 90 35L 32	F9L2045	1"1/4	32	50	M 45x2	151,5	26	82	97	b
DKOL 90 42L 38	F9L2452	1"1/2	38	60	M 52x2	176,5	32	95	118,5	b

HYDROWEB

Raccordi Femmina Filetto metrico Sede 24° ISO 12151-2 (ISO 8434-1) Serie leggera con O-Ring
 Metric Females 24° Cone ISO 12151-2 (ISO 8434-1) Light with O-Ring
 Metrisch 24° Dichtkegel ISO 12151-2 (ISO 8434-1) Leicht mit O-Ring

F4L

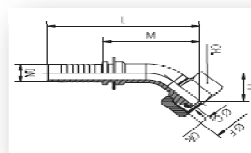

LEGENDA										
a PRESSATO										
b LIBERO										
DESCRIZIONE	CODICE	DN	TUBO	CH	FILETTO F	L	C	H	M	
DKOL 45 06L 05	F4L0312	3/16"	05	14	M 12x1,5	56	3	15	34	b
DKOL 45 08L 06	F4L0414	1/4"	06	17	M 14x1,5	63	4	15	35	b
DKOL 45 10L 06	F4L0416	1/4"	06	19	M 16x1,5	64,5	4	17	36,5	b
DKOL 45 10L 08	F4L0516	5/16"	08	19	M 16x1,5	66	5,5	16,5	38	b
DKOL 45 10L 10	F4L0616	3/8"	10	19	M 16x1,5	74	6,5	22	44,5	a
DKOL 45 12L 10	F4L0618	3/8"	10	22	M 18x1,5	72,5	7	19,5	43	b
DKOL 45 15L 13	F4L0822	1/2"	13	27	M 22x1,5	81	9,5	20	51,5	b
DKOL 45 18L 16	F4L1026	5/8"	16	32	M 26x1,5	96	12,5	24,5	62	b
DKOL 45 22L 19	F4L1230	3/4"	19	36	M 30x2	106	15	27	67	b
DKOL 45 28L 25	F4L1636	1"	25	41	M 36x2	132	19,5	29,5	85	b
DKOL 45 35L 32	F4L2045	1"1/4	32	50	M 45x2	159	26	38,5	104,5	b
DKOL 45 42L 38	F4L2452	1"1/2	38	60	M 52x2	181,5	32	42,5	123,5	b

Raccordi Femmina Filetto metrico Sede 24° ISO 12151-2 (ISO 8434-1) Serie pesante con O-Ring
 Metric Females 24° Cone ISO 12151-2 (ISO 8434-1) Heavy with O-Ring
 Metrisch 24° Dichtkegel ISO 12151-2 (ISO 8434-1) Schwer mit O-Ring

FDS

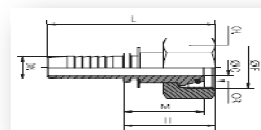

DESCRIZIONE	CODICE	DN	TUBO	CH	FILETTO F	L	C	H	M	
DKOS 08S 05	FDS0316	3/16"	05	19	M 16x1,5	51,5	3	29,5	25,5	b
DKOS 08S 06	FDS0416	1/4"	06	19	M 16x1,5	57,5	4	29,5	26	b
DKOS 10S 06	FDS0418	1/4"	06	22	M 18x1,5	58	4	30	27	b
DKOS 12S 08	FDS0520	5/16"	08	24	M 20x1,5	58	5,5	30	27	b
DKOS 12S 10	FDS0620	3/8"	10	24	M 20x1,5	59,5	7	30	27	b
DKOS 14S 10	FDS0622	3/8"	10	27	M 22x1,5	65	7	35,5	30,5	b
DKOS 16S 13	FDS0824	1/2"	13	30	M 24x1,5	66	9,5	36,5	31,5	b
DKOS 20S 16	FDS1030	5/8"	16	36	M 30x2	76	12,5	42	37	b
DKOS 20S 19	FDS1230	3/4"	19	36	M 30x2	83	15	44	39	b
DKOS 25S 19	FDS1236	3/4"	19	46	M 36x2	87,5	15	48,5	42	b
DKOS 25S 25	FDS1636	1"	25	46	M 36x2	88,5	19,5	41,5	35	a
DKOS 30S 25	FDS1642	1"	25	50	M 42x2	99	19,5	52	45	b
DKOS 38S 32	FDS2052	1"1/4	32	60	M 52x2	114,5	26	60	50	b

Raccordi Femmina Filetto metrico Sede 24° ISO 12151-2 (ISO 8434-1) Serie pesante con O-Ring
 Metric Females 24° Cone ISO 12151-2 (ISO 8434-1) Heavy with O-Ring
 Metrisch 24° Dichtkegel ISO 12151-2 (ISO 8434-1) Schwer mit O-Ring

F9S

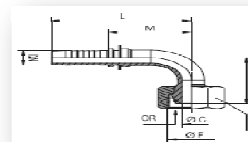

DESCRIZIONE	CODICE	DN	TUBO	CH	FILETTO F	L	C	H	M	
DKOS 90 08S 05	F9S0316	3/16"	05	19	M 16x1,5	48,5	3	29,5	26,5	b
DKOS 90 08S 06	F9S0416	1/4"	06	19	M 16x1,5	55	4	32,5	27	b
DKOS 90 10S 06	F9D0418	1/4"	06	22	M 18x1,5	55	4	33,5	27	b
DKOS 90 12S 08	F9S0520	5/16"	08	24	M 20x1,5	58	5,5	34	30	b
DKOS 90 12S 10	F9S0620	3/8"	10	24	M 20x1,5	64	7	37,5	34,5	b
DKOS 90 14S 10	F9S0622	3/8"	10	27	M 22x1,5	64	7	38,5	34,5	b
DKOS 90 16S 13	F9S0824	1/2"	13	30	M 24x1,5	72,5	9,5	43	43	b
DKOS 90 20S 16	F9S1030	5/8"	16	36	M 30x2	88	12,5	55	54	b
DKOS 90 20S 19	F9S1230	3/4"	19	36	M 30x2	99,5	15	58,5	60,5	b
DKOS 90 25S 19	F9S1236	3/4"	19	46	M 36x2	99,5	15	59,5	60,5	b
DKOS 90 25S 25	F9S1636	1"	25	46	M 36x2	126	19,5	80,5	79	a
DKOS 90 30S 25	F9S1642	1"	25	50	M 42x2	127	19,5	71	80	b
DKOS 90 38S 32	F9S2052	1"1/4	32	60	M 52x2	151,5	26	85	97	b